



Serving your real estate needs since 1968

106 S. Main St., Monona, IA 52159

(563)539-2015

freedomagencymonona.com

Jim Moritz, Broker Cell: 563-880-8189

Isaac Brehmer, Sales Associate Cell: 563-880-6428



**Norma Brau, 402 S West St., Monona, IA 52159**

**\$72,500.00**

Size of Lot: 72' x 132'

Type of Home: Ranch

House square footage: 864 sq ft

Year home built: 1968

Type of siding: Vinyl

Type of roof: Asphalt

Foundation: Concrete Block

Windows: Combination & replacement

Size/Type of Garage: 1 car attached, 384 sq ft

Type of Furnace: Goodman, forced air

Estimated Annual Heating Cost: 12 month avg: \$57.00

Water Heater: Bradford White, 40 gallon, gas

Wiring/Electric Service: Fuse panel

Estimated Annual Electrical: 12 month avg: \$62.00

Water/Sewer: City

Air conditioning: Central Air-Lennox

School District: MFL MarMac Community Schools

Street/Road Surface: Concrete

Driveway Surface: Concrete

Property Taxes-Gross: \$1,465.31

Property Taxes-Net: \$1,466.00

Assessed Valuation: \$71,519.00

**Rooms/Approximate Size:**

Kitchen:	11.6' x 13.1'
Dining room/Living room:	17.5' x 11.6'
Full Bathroom:	9.4' x 8.1'
Bedroom:	11.7' x 11.5'
Bedroom:	11.5' x 7.7'
Bedroom:	11.5' x 7.11'

# FreedomAgency



Living room



Kitchen



Back patio



Back Yard

# FreedomAgency



Bathroom



Bedroom #1



Bedroom #2



Bedroom #3





## Summary

Parcel ID 36-14-236-005  
 Alternate ID  
 Property Address 402 S WEST ST  
 MONONA  
 Sec/Twp/Rng N/A  
 Brief Tax Description S 6 FT LOT 56 & LOT 57 NE NE 14 95 5  
 (Note: Not to be used on legal documents)  
 Deed Book/Page 2019R00928 (4/9/2019)  
 Contract Book/Page  
 Gross Acres 0.00  
 Net Acres 0.00  
 Class R - Residential  
 (Note: This is for tax purposes only. Not to be used for zoning.)  
 District MO MF - MO MF  
 School District MFL MarMac School



## Owners

Deed Holder  
[Brau Norma J](#)  
 22480 230th St  
 St Olaf IA 52072

Contract Holder

Mailing Address  
 Brau Norma J  
 22480 230th St  
 St Olaf IA 52072

## Land

Lot Dimensions Regular Lot: 72.00 x 132.00  
 Lot Area 0.22 Acres; 9,504 SF

## Residential Dwellings

Residential Dwelling  
 Occupancy Single-Family / Owner Occupied  
 Style 1 Story Frame  
 Architectural Style N/A  
 Year Built 1968  
 Condition Very Good  
 Grade [what's this?](#) 4-5  
 Roof Asph / Hip  
 Flooring CARPET VINYL  
 Foundation C Blk  
 Exterior Material None  
 Interior Material Drwl / Panel  
 Brick or Stone Veneer  
 Total Gross Living Area 864 SF  
 Attic Type None;  
 Number of Rooms 5 above; 0 below  
 Number of Bedrooms 3 above; 0 below  
 Basement Area Type None  
 Basement Area 0  
 Basement Finished Area  
 Plumbing 1 Full Bath;  
 Appliances  
 Central Air Yes  
 Heat FHA - Gas  
 Fireplaces  
 Porches  
 Decks Concrete Patio-Med (480 SF);  
 Additions  
 Garages 384 SF - Att Frame (Built 1968);

## Sales

Date	Seller	Buyer	Recording	Sale Condition - NUTC	Type	Multi Parcel	Amount
4/9/2019	BRAU, CHARLES & NORMA J.	BRAU NORMA J	2019R00928	Normal	Deed	Y	\$0.00
12/17/1992			88/264	NORMAL ARMS-LENGTH TRANSACTION	Deed		\$16,500.00

⊞ There are other parcels involved in one or more of the above sales:

[Recording: 2019R00928 - Parcel: 1107128001](#)

[Recording: 2019R00928 - Parcel: 1107128002](#)

**Valuation**

Classification	2020 Residential	2019 Residential	2018 Residential	2017 Residential	2016 Residential
+ Assessed Land Value	\$11,124	\$11,124	\$11,124	\$11,124	\$11,124
+ Assessed Building Value	\$0	\$0	\$0	\$0	\$0
+ Assessed Dwelling Value	\$60,395	\$60,395	\$60,203	\$60,203	\$60,203
= Gross Assessed Value	\$71,519	\$71,519	\$71,327	\$71,327	\$71,327
- Exempt Value	\$0	\$0	\$0	\$0	\$0
= Net Assessed Value	\$71,519	\$71,519	\$71,327	\$71,327	\$71,327

**Taxation**

	2019 Pay 2020-2021	2018 Pay 2019-2020	2017 Pay 2018-2019	2016 Pay 2017-2018
+ Taxable Land Value	\$6,126	\$6,332	\$6,187	\$6,334
+ Taxable Building Value	\$0	\$0	\$0	\$0
+ Taxable Dwelling Value	\$33,262	\$34,266	\$33,485	\$34,279
= Gross Taxable Value	\$39,389	\$40,598	\$39,673	\$40,613
- Military Credit	\$0	\$0	\$0	\$0
= Net Taxable Value	\$39,389	\$40,598	\$39,673	\$40,613
x Levy Rate (per \$1000 of value)	37.20139	36.89672	37.36569	37.36767
= Gross Taxes Due	\$1,465.31	\$1,497.93	\$1,482.40	\$1,517.61
- Ag Land Credit	\$0.00	\$0.00	\$0.00	\$0.00
- Family Farm Credit	\$0.00	\$0.00	\$0.00	\$0.00
- Homestead Credit	\$0.00	\$0.00	\$0.00	\$0.00
- Disabled and Senior Citizens Credit	\$0.00	\$0.00	\$0.00	\$0.00
- Business Property Credit	\$0.00	\$0.00	\$0.00	\$0.00
= Net Taxes Due	\$1,466.00	\$1,498.00	\$1,482.00	\$1,518.00

**Tax History**

Year	Due Date	Amount	Paid	Date Paid	Receipt
2019	March 2021	\$733	No		720882
	September 2020	\$733	Yes	9/9/2020	
2018	March 2020	\$749	Yes	3/25/2020	620902
	September 2019	\$749	Yes	9/23/2019	
2017	March 2019	\$741	Yes	3/8/2019	520717
	September 2018	\$741	Yes	9/5/2018	
2016	March 2018	\$759	Yes	3/21/2018	426867
	September 2017	\$759	Yes	8/29/2017	
2015	March 2017	\$620	Yes	3/28/2017	327453
	September 2016	\$620	Yes	9/26/2016	
2014	March 2016	\$633	Yes	3/28/2016	228401
	September 2015	\$633	Yes	9/22/2015	

**2020 Tax Statements**
[3614236005\(PDF\)](#)
**Homestead Tax Credit Application**
[Apply online for the Iowa Homestead Tax Credit](#)
**Iowa Land Records**
[View Deed \(2019R00928\)](#)

Data for Clayton County between Beacon and Iowa Land Records is available on the Iowa Land Records site beginning in 2006.  
For records prior to 2006, contact the County Recorder or Customer Support at [www.iowaLandRecords.org](http://www.iowaLandRecords.org).

**Photos**



## Sketches

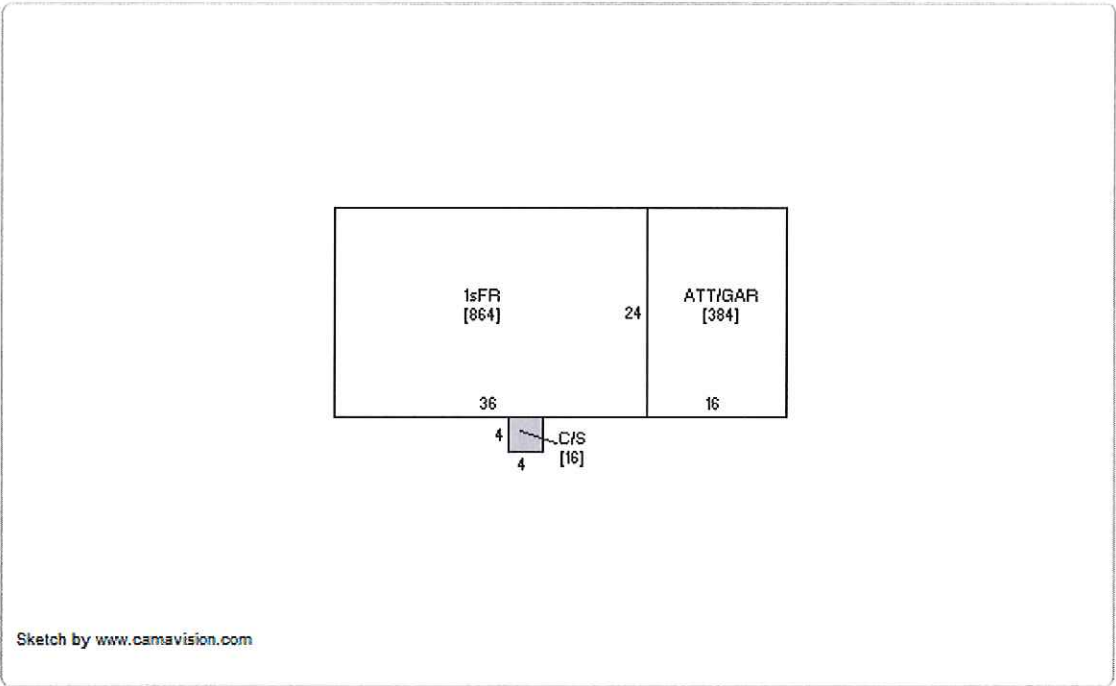
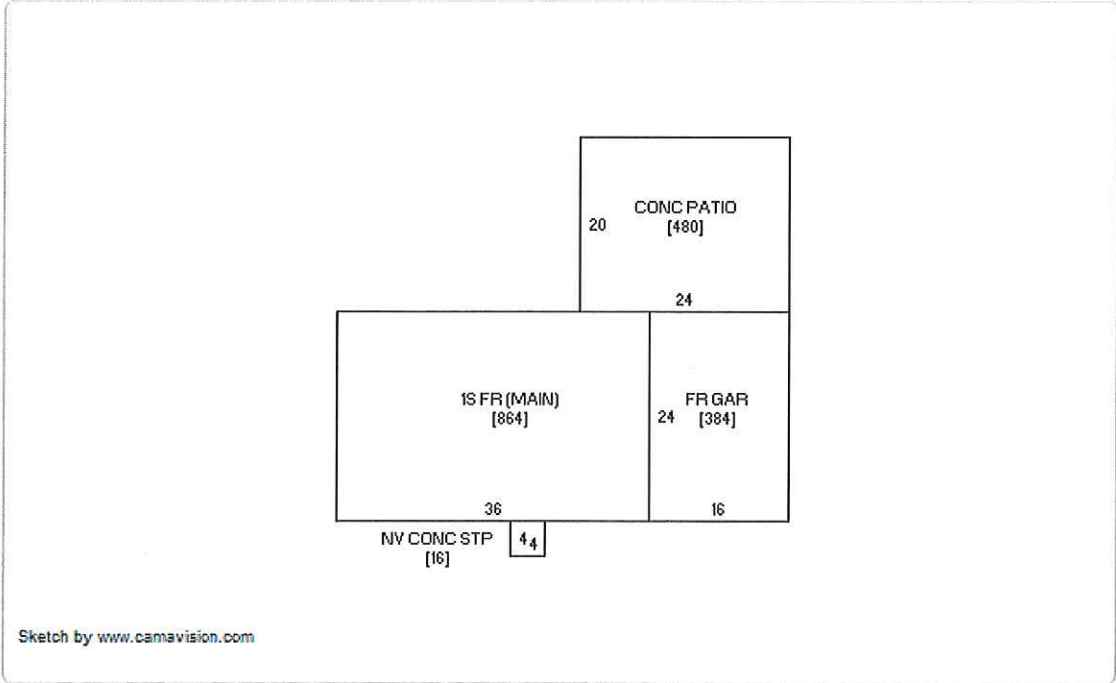

No data available for the following modules: Doing Business AS, Ag Soils, Commercial Buildings, Agricultural Buildings, Yard Extras, Special Assessments.

Disclaimer: The information in this web site represents current data from a working file which is updated continuously. This information is used for property tax purposes only and is available as a reference for information that is believed reliable, but its accuracy cannot be guaranteed. Clayton County Assessors office does not determine the ownership of any real property.

[User Privacy Policy](#)  
[GDPR Privacy Notice](#)

Last Data Upload: 9/22/2020, 1:42:34 AM

Version 2.3.86

Developed by  
 Schneider  
GEOSPATIAL





# SELLER DISCLOSURE OF PROPERTY CONDITION

(To be delivered prior to buyer making Offer to Buy Real Estate)



## Property Owner(s) & Address:

402 South West Street Monona, IA

**Purpose of Disclosure:** Completion of Section I this form is required under Chapter 558A of the Iowa code which mandates the Seller(s) disclose condition and information about the property, unless exempt:

**Exempt Properties:** Properties exempted from the Seller's disclosure requirement include (IA Code 558A): Bare ground; property containing 5 or more dwellings units; court ordered transfers; transfers by a power of attorney; foreclosures; lenders selling foreclosed properties; transfers by a fiduciary in the course of the administration of a decedent's estate, guardianship, conservatorship, or trust. This exemption shall not apply to a transfer of real estate in which the fiduciary is a living natural person and was an occupant in possession of the real estate at any time within the twelve consecutive months immediately preceding the date of transfer; between joint tenants, or tenants in common; to or from any governmental division; quit claim deeds; intra family transfers; between divorcing spouses; commercial or agricultural property which has no dwellings. Seller(s) certifies that the property is exempt from the requirement(s) of Iowa Code 558A because one of the above exemptions apply.

If claiming an exemption, sign here and stop.

Seller _____	Date _____	Seller _____	Date _____
Buyer _____	Date _____	Buyer _____	Date _____

**Instructions to the Seller:** (1) Complete this form yourself. (2) Report known conditions materially affecting the property and utilize ordinary care in obtaining the information. (3) Provide information in good faith and make a reasonable effort to ascertain the required information. (4) Additional pages or reports may be attached. (5) If some items do not apply to your property, write "NA" (not applicable). (6) All approximations must be identified "AP". If you do not know the facts, write or check UNKNOWN. (7) Keep a copy of this statement.

**Seller's Disclosure Statement:** Seller discloses the following information regarding the property and certifies this information is true and accurate to the best of my/our knowledge as of the date signed. Seller authorizes Agent to provide a copy of this statement to any person or entity in connection with actual or anticipated sale of the property or as otherwise provided by law. This statement shall not be a warranty of any kind by Seller or Seller's Agent and shall not be intended as a substitute for any inspection or warranty the purchaser may wish to obtain. The following are representations made by Seller and are not by any Agent acting on behalf of the Seller. **The Agent has no independent knowledge of the condition of the property except that which is written on this form. Seller advises Buyer to obtain independent inspections relevant to Buyer.**

Seller initials NB Buyer initials \_\_\_\_\_

## I. Property Conditions, Improvements and Additional Information: (Section I is Mandatory)

EACH AND EVERY LINE MUST BE ADDRESSED AND MARKED

1. **Basement/Foundation:** Has there been known water or other problems? Yes ☐ No ☐ Unknown ☒ NA  
1A. If yes, please explain: \_\_\_\_\_
2. **Roof:** Any known problems? Yes ☐ No ☒ Unknown ☐  
2A. Type Asphalt  
2B. Date of repairs/replacement (If any) Approx - 6 years old  
Describe: New Shingles
3. **Well and pump:** Any known problems? Yes ☐ No ☐ Unknown ☒ city water  
3A. Type of well (depth/diameter), age and date of repair: \_\_\_\_\_



3B. Has the water been tested? Yes ☐ No ☒ Unknown ☐

3C. If yes, date of last report/results: \_\_\_\_\_

4. **Septic tanks/drain fields:** Any known problems? Yes ☐ No ☐ Unknown ☐ City Sewer

Location of tank \_\_\_\_\_ Age \_\_\_\_\_ Unknown ☐

Has the system been pumped and inspected within the last 2 years?

Yes ☐ No ☐ Unknown ☐

Date of inspection \_\_\_\_\_ Date tank last cleaned/pumped \_\_\_\_\_ N/A ☐

5. **Sewer:** Any known problems? Yes ☐ No ☒ Unknown ☐

5A. Any known repairs/replacement? Yes ☐ No ☒ Unknown ☐

5B. Date of repairs \_\_\_\_\_

6. **Heating system(s):** Any known problems? Yes ☐ No ☒

6A. Any known repairs/replacement? Yes ☒ No ☐

6B. Date of repairs new furnace March 2020

7. **Central Cooling system(s):** Any known problems? Yes ☐ No ☒

7A. Any known repairs/replacement? Yes ☐ No ☒

7B. Date of repairs \_\_\_\_\_

8. **Plumbing system(s):** Any known problems? Yes ☐ No ☒

8A. Any known repairs/replacement? Yes ☐ No ☒

8B. Date of repairs \_\_\_\_\_

9. **Electrical system(s):** Any known problems? Yes ☐ No ☒

9A. Any known repairs/replacement? Yes ☐ No ☒

9B. Date of repairs \_\_\_\_\_

10. **Pest Infestation:** (wood-destroying insects, bats, snakes, rodents, destructive/troublesome animals, etc.)

10A. Any known problems? Yes ☐ No ☒ Unknown ☐

Date of treatment \_\_\_\_\_

10B. Previous Infestation/Structural Damage? Yes ☐ No ☒ Unknown ☐

Date of repairs \_\_\_\_\_

11. **Asbestos:** Is asbestos present in any form in the property? Yes ☐ No ☒ Unknown ☐

11A. If yes, explain: \_\_\_\_\_

12. **Radon:** Any known tests for the presence of radon gas? Yes ☐ No ☒

12A. If yes, test results? \_\_\_\_\_ Date of last report \_\_\_\_\_

13. **Lead Based Paint:** Known to be present or has the property been tested for the presence of lead based paint?

Yes ☐ No ☒ Unknown ☐

13A. Provide lead based paint disclosure.

14. **Any known encroachments, easements, "common areas"** (facilities like pools, tennis courts, walkways or other areas co-owned with others), zoning matters, nonconforming uses, or a Homeowners Association which has any authority over the property? Yes ☐ No ☒ Unknown ☐

15. Features of the property known to be shared in common with adjoining landowners, such as walls, fences, roads and driveways whose use or maintenance responsibility may have an effect on the property?

Yes ☐ No ☒ Unknown ☐

16. Structural Damage: Any known structural damage? Yes ☐ No ☒ Unknown ☐

17. Physical Problems: Any known settling, flooding, drainage or grading problems? Yes ☐ No ☒ Unknown ☐

18. Is the property located in a flood plain? Yes ☐ No ☒ Unknown ☐

18A. If yes, flood plain designation \_\_\_\_\_

19. Do you know the zoning classification of this property? Yes ☒ No ☐ Unknown ☐

What is the zoning? residential

20. Covenants: Is the property subject to restrictive covenants? Yes ☐ No ☒ Unknown ☐

If yes, attach a copy OR state where a true, current copy of the covenants can be obtained:

☐ On file at County Recorder's office or: \_\_\_\_\_

You **MUST** explain any "Yes" responses above (Attach additional sheets if necessary): \_\_\_\_\_

Seller initials NB

Buyer initials \_\_\_\_\_

## II. Appliances/Systems/Services (Note: Section II is for the convenience of Buyer/Seller and is not mandatory):

**Notice:** Items marked "included" are intended to remain with the property after sale. However, included items may be negotiable between Buyer and Seller, and requested items should be in writing as either included or excluded in any Offer to Buy/Purchase Agreement. The Offer to Buy/Purchase Agreement shall be the final terms of any agreement.

	Working?					Working?			
	Included	Yes	No	OR N/A		Included	Yes	No	OR N/A
Range/Oven	<input checked="" type="checkbox"/>	<input checked="" type="checkbox"/>	<input type="checkbox"/>	<input type="checkbox"/>	Lawn Sprinkler System	<input checked="" type="checkbox"/>	<input type="checkbox"/>	<input type="checkbox"/>	<input type="checkbox"/>
Dishwasher <u>NA</u>	<input type="checkbox"/>	<input type="checkbox"/>	<input type="checkbox"/>	<input type="checkbox"/>	Solar Heating System <u>NA</u>	<input type="checkbox"/>	<input type="checkbox"/>	<input type="checkbox"/>	<input type="checkbox"/>
Refrigerator	<input checked="" type="checkbox"/>	<input checked="" type="checkbox"/>	<input type="checkbox"/>	<input type="checkbox"/>	Pool Heater, Wall <u>NA</u>	<input type="checkbox"/>	<input type="checkbox"/>	<input type="checkbox"/>	<input type="checkbox"/>
Hood/Fan <u>NA</u>	<input type="checkbox"/>	<input type="checkbox"/>	<input type="checkbox"/>	<input type="checkbox"/>	liner & equipment	<input type="checkbox"/>	<input type="checkbox"/>	<input type="checkbox"/>	<input type="checkbox"/>
Disposal <u>NA</u>	<input type="checkbox"/>	<input type="checkbox"/>	<input type="checkbox"/>	<input type="checkbox"/>	Well & Pump <u>NA</u>	<input type="checkbox"/>	<input type="checkbox"/>	<input type="checkbox"/>	<input type="checkbox"/>
TV receiving <u>NA</u>	<input type="checkbox"/>	<input type="checkbox"/>	<input type="checkbox"/>	<input type="checkbox"/>	Smoke Alarm	<input checked="" type="checkbox"/>	<input checked="" type="checkbox"/>	<input type="checkbox"/>	<input type="checkbox"/>
Equipment	<input type="checkbox"/>	<input type="checkbox"/>	<input type="checkbox"/>	<input type="checkbox"/>	Septic Tank & <u>NA</u>	<input type="checkbox"/>	<input type="checkbox"/>	<input type="checkbox"/>	<input type="checkbox"/>
Sump Pump <u>NA</u>	<input type="checkbox"/>	<input type="checkbox"/>	<input type="checkbox"/>	<input type="checkbox"/>	Drain field	<input type="checkbox"/>	<input checked="" type="checkbox"/>	<input type="checkbox"/>	<input type="checkbox"/>
Alarm System <u>NA</u>	<input type="checkbox"/>	<input type="checkbox"/>	<input type="checkbox"/>	<input type="checkbox"/>	City Water System	<input type="checkbox"/>	<input checked="" type="checkbox"/>	<input type="checkbox"/>	<input type="checkbox"/>
Central AC	<input checked="" type="checkbox"/>	<input checked="" type="checkbox"/>	<input type="checkbox"/>	<input type="checkbox"/>	City Sewer System	<input type="checkbox"/>	<input checked="" type="checkbox"/>	<input type="checkbox"/>	<input type="checkbox"/>
Window AC <u>NA</u>	<input type="checkbox"/>	<input type="checkbox"/>	<input type="checkbox"/>	<input type="checkbox"/>	Plumbing System	<input type="checkbox"/>	<input checked="" type="checkbox"/>	<input type="checkbox"/>	<input type="checkbox"/>
Central Vacuum <u>NA</u>	<input type="checkbox"/>	<input type="checkbox"/>	<input type="checkbox"/>	<input type="checkbox"/>	Central Heating System	<input type="checkbox"/>	<input checked="" type="checkbox"/>	<input type="checkbox"/>	<input type="checkbox"/>
Gas Grill <u>NA</u>	<input type="checkbox"/>	<input type="checkbox"/>	<input type="checkbox"/>	<input type="checkbox"/>	Water Heater	<input type="checkbox"/>	<input checked="" type="checkbox"/>	<input type="checkbox"/>	<input type="checkbox"/>
Attic Fan <u>NA</u>	<input type="checkbox"/>	<input type="checkbox"/>	<input type="checkbox"/>	<input type="checkbox"/>	Windows	<input type="checkbox"/>	<input checked="" type="checkbox"/>	<input type="checkbox"/>	<input type="checkbox"/>
Intercom <u>NA</u>	<input type="checkbox"/>	<input type="checkbox"/>	<input type="checkbox"/>	<input type="checkbox"/>	Fireplace/Chimney <u>NA</u>	<input type="checkbox"/>	<input type="checkbox"/>	<input type="checkbox"/>	<input type="checkbox"/>
Microwave <u>NA</u>	<input type="checkbox"/>	<input type="checkbox"/>	<input type="checkbox"/>	<input type="checkbox"/>	Wood Burning System <u>NA</u>	<input type="checkbox"/>	<input type="checkbox"/>	<input type="checkbox"/>	<input type="checkbox"/>
Trash Compactor <u>NA</u>	<input type="checkbox"/>	<input type="checkbox"/>	<input type="checkbox"/>	<input type="checkbox"/>	Furnace Humidifier <u>NA</u>	<input type="checkbox"/>	<input type="checkbox"/>	<input type="checkbox"/>	<input type="checkbox"/>
Ceiling Fan <u>NA</u>	<input type="checkbox"/>	<input type="checkbox"/>	<input type="checkbox"/>	<input type="checkbox"/>	Sauna/Hot tub <u>NA</u>	<input type="checkbox"/>	<input type="checkbox"/>	<input type="checkbox"/>	<input type="checkbox"/>
Water Softener/ <u>NA</u>	<input type="checkbox"/>	<input type="checkbox"/>	<input type="checkbox"/>	<input type="checkbox"/>	Locks and Keys	<input checked="" type="checkbox"/>	<input checked="" type="checkbox"/>	<input type="checkbox"/>	<input type="checkbox"/>
Conditioner	<input type="checkbox"/>	<input type="checkbox"/>	<input type="checkbox"/>	<input type="checkbox"/>	Dryer	<input checked="" type="checkbox"/>	<input checked="" type="checkbox"/>	<input type="checkbox"/>	<input type="checkbox"/>
LP Tanks <u>NA</u>	<input type="checkbox"/>	<input type="checkbox"/>	<input type="checkbox"/>	<input type="checkbox"/>	Washer	<input checked="" type="checkbox"/>	<input checked="" type="checkbox"/>	<input type="checkbox"/>	<input type="checkbox"/>
Keys & Locks	<input type="checkbox"/>	<input type="checkbox"/>	<input type="checkbox"/>	<input type="checkbox"/>	Storage Shed <u>NA</u>	<input type="checkbox"/>	<input type="checkbox"/>	<input type="checkbox"/>	<input type="checkbox"/>
Swing Set <u>NA</u>	<input type="checkbox"/>	<input type="checkbox"/>	<input type="checkbox"/>	<input type="checkbox"/>	Underground	<input type="checkbox"/>	<input type="checkbox"/>	<input type="checkbox"/>	<input type="checkbox"/>
Basketball Hoop <u>NA</u>	<input type="checkbox"/>	<input type="checkbox"/>	<input type="checkbox"/>	<input type="checkbox"/>	"Pet fence" <u>NA</u>	<input type="checkbox"/>	<input type="checkbox"/>	<input type="checkbox"/>	<input type="checkbox"/>
Boat Hoist <u>NA</u>	<input type="checkbox"/>	<input type="checkbox"/>	<input type="checkbox"/>	<input type="checkbox"/>	Boat Dock <u>NA</u>	<input type="checkbox"/>	<input type="checkbox"/>	<input type="checkbox"/>	<input type="checkbox"/>
Pet Collars <u>NA</u>	<input type="checkbox"/>	<input type="checkbox"/>	<input type="checkbox"/>	<input type="checkbox"/>					
Garage door opener	<input checked="" type="checkbox"/>	<input checked="" type="checkbox"/>	<input type="checkbox"/>	<input type="checkbox"/>					

# of collars

# of remotes 1

Exceptions/Explanations for "NO" responses above: \_\_\_\_\_

\_\_\_\_\_

\_\_\_\_\_

\_\_\_\_\_

**ALL HOUSEHOLD APPLIANCES ARE NOT UNDER WARRANTY BEYOND DATE OF CLOSING.**  
Warranties may be available for purchase from independent warranty companies.

Seller initials NB Buyer initials \_\_\_\_\_

**III. Additional Non-Mandatory Requested Items:** Are you as the Seller aware of any of the following:

1. Any significant structural modification or alteration to property? Yes ☐ No ☒ Unknown ☐ Please explain: \_\_\_\_\_
2. Has there been a property/casualty loss over \$5,000, an insurance claim over \$5,000, OR major damage to the property from fire, wind, hail, flood(s) or other conditions? Yes ☐ No ☒ Unknown ☐ If yes, has the damage been repaired/replaced? Yes ☐ No ☐
3. Are there any known current, preliminary, proposed or future assessments by any governing body or owner's association of which you have knowledge? Yes ☐ No ☒ Unknown ☐
4. Mold: Does property contain toxic mold that adversely affects the property or occupants? Yes ☐ No ☒ Unknown ☐
5. Private burial grounds: Does property contain any private burial ground? Yes ☐ No ☒ Unknown ☐
6. Neighborhood or Stigmatizing conditions or problems affecting this property? Yes ☐ No ☒ Unknown ☐
7. Energy Efficiency Testing: Has the property been tested for energy efficiency? Yes ☐ No ☒ Unknown ☐  
If yes, what were the test results? \_\_\_\_\_
8. Attic Insulation: Type blown Unknown ☐ Amount \_\_\_\_\_ Unknown ☒
9. Are you aware of any area environmental concerns? Yes ☐ No ☒ Unknown ☐ If yes, please explain: \_\_\_\_\_
10. Are you related to the listing agent? Yes ☐ No ☒ If yes, how? \_\_\_\_\_
11. Where survey of property may be found: Court records
12. Wind Farms: Is the subject property encumbered by certain Wind Energy rights? Yes ☐ No ☒ NA  
If yes, rights by: Lease ☐ , Easement ☐ , Other ☐ Define Other: \_\_\_\_\_  
Wind Farm Company, Owner: \_\_\_\_\_

If the answer to any item is yes, please explain. Attach additional sheets, if necessary: \_\_\_\_\_

\_\_\_\_\_

\_\_\_\_\_

\_\_\_\_\_

**13. Repairs:** Any repair(s) to property not so noted: (Date of repairs, Name of repair company if utilized.) (Note: Repairs are not normal maintenance items) (Attach additional sheets, if necessary) \_\_\_\_\_

#### IV. Radon Fact Sheet & Form Acknowledgement

**Seller acknowledges that Buyer be provided with and the Buyer acknowledges receipt of the "Iowa Radon Home-Buyers and Sellers Fact Sheet", prepared by the Iowa Department of Public Health.**

Seller Norma Brare Seller \_\_\_\_\_ Date 9-18-20

Seller has owned the property since 1992 (date). Seller has indicated above the history and condition of all the items based solely on the information known or reasonably available to the Seller(s). If any changes occur in the structural/mechanical/appliance systems of this property from the date of this form to the date of closing, Seller will immediately disclose the changes to Buyer. In no event shall the parties hold Broker liable for any representations not directly made by Broker or Broker's affiliated licensees (brokers and salespersons). **Seller hereby acknowledges Seller has retained a copy of this statement.**

**Buyer hereby acknowledges receipt of a copy of this statement. This statement is not intended to be a warranty or to substitute for any inspection the buyer(s) may wish to obtain.**

Buyer \_\_\_\_\_ Buyer \_\_\_\_\_ Date \_\_\_\_\_



**DISCLOSURE OF INFORMATION AND ACKNOWLEDGMENT:  
LEAD-BASED PAINT AND/OR LEAD-BASED PAINT HAZARDS**

**Address:** 402 S WEST ST. MONONA, IA 52159

**Lead Warning Statement**

Every purchaser of any interest in residential real property on which a residential dwelling was built prior to 1978 is notified that such property may present exposure to lead from lead-based paint that may place young children at risk of developing lead poisoning. Lead poisoning in young children may produce permanent neurological damage, including learning disabilities, reduced intelligence quotient, behavioral problems, and impaired memory. Lead poisoning also poses a particular risk to pregnant women. The seller of any interest in residential real property is required to provide the buyer with any information on lead-based paint hazards from risk assessments or inspections in the seller's possession and notify the buyer of any known lead-based paint hazards. A risk assessment or inspection for possible lead-based paint hazards is recommended prior to purchase.

**SELLER'S DISCLOSURE (initial)**

AB (a) Presence of lead-based paint and/or lead-based paint hazards (check one below):

☐ Known lead-based paint and/or lead-based paint hazards are present in the housing (explain).

☒ Seller has no knowledge of lead-based paint and/or lead-based paint hazards in the housing.

AB (b) Records and Reports available to the Seller (check one below):

☐ Seller has provided the Purchaser with all available records and reports pertaining to lead-based paint and/or lead-based paint hazards in the housing (list documents below).

☒ Seller has no reports or records pertaining to lead-based paint and/or lead-based paint hazards in the housing.

**PURCHASER'S ACKNOWLEDGEMENT (initial)**

\_\_\_\_ (c) ☐ Purchaser has received copies of all information listed above.  
or, ☐ No Records or Reports were available (see (b) above).

\_\_\_\_ (d) Purchaser has received the pamphlet *Protect Your Family from Lead in Your Home, Lead Poisoning: How to Protect Iowa Families*.

\_\_\_\_ (e) Purchaser has (check one below):

☐ Received a 10-day opportunity (or mutually agreed upon period) to conduct a risk assessment or inspection for the presence of lead-based paint and/or lead-based paint hazards; or

☐ Waived the opportunity to conduct a risk assessment or inspection for the presence of lead based paint and/or lead-based paint hazards.

**AGENT'S ACKNOWLEDGEMENT (initial)**

JA (f) Agent has informed the Seller of the Seller's obligations under 42 U.S.C. 4852d and is aware of his/her responsibility to ensure compliance.

**CERTIFICATE OF ACCURACY**

The following parties have reviewed the information above and certify, to the best of their knowledge, that the information provided by the signatory is true and accurate:

<u>Norma Brace</u>	<u>9-18-20</u>		
Seller	Date	Purchaser	Date

<u>[Signature]</u>	<u>9-18-20</u>		
Seller's Agent	Date	Purchaser's Agent	Date